

GUIDE LINEARI



Ajusic

LINEAR GUIDES





TESTATA DI TRAINO - DRIVE HEAD

CODICE CODE	DESCRIZIONE DESCRIPTION
800.040.201	Testata di traino per guide serie 800.010 e 800.030 <i>Drive head for guides series 800.010 and 800.030</i>



TESTATA DI RINVIO - IDLER HEAD

CODICE CODE	DESCRIZIONE DESCRIPTION
800.040.202	Testata di rinvio per guide serie 800.010 e 800.030 <i>Idler head for guides series 800.010 and 800.030</i>



CARRELLO MOBILE - MOVABLE TROLLEY

CODICE CODE	DESCRIZIONE DESCRIPTION
800.040.203	Carrello mobile per guide serie 800.010 <i>Movable trolley for guides series 800.010</i>



TESTATA DI TRAINO - DRIVE HEAD

CODICE CODE	DESCRIZIONE DESCRIPTION
800.040.301	Testata di traino per guide serie 800.020 <i>Drive head for guides series 800.020</i>



TESTATA DI RINVIO - IDLER HEAD

CODICE CODE	DESCRIZIONE DESCRIPTION
800.040.302	Testata di rinvio per guide serie 800.020 <i>Idler head for guides series 800.020</i>

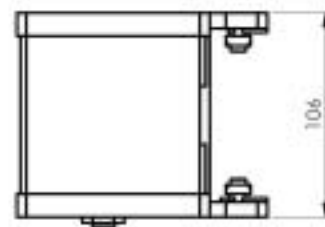
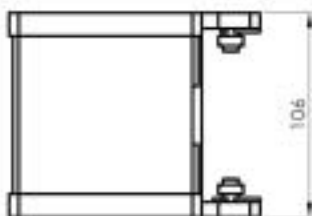
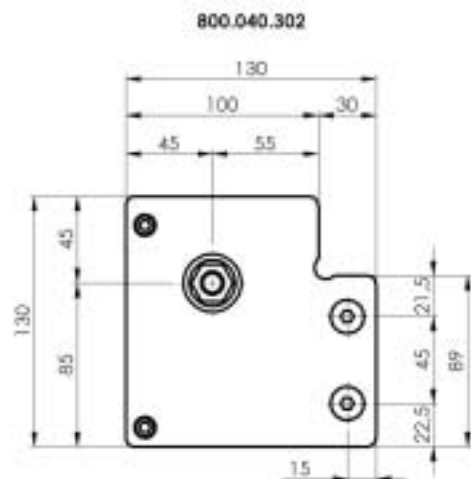
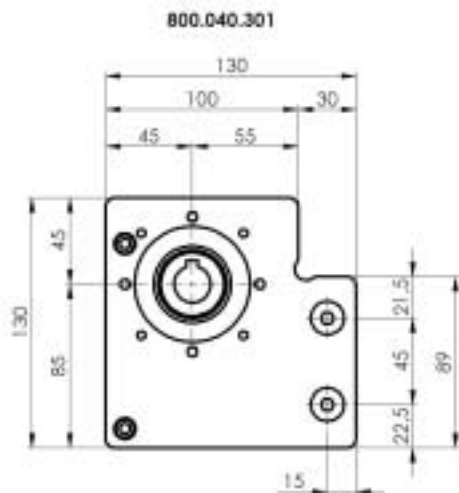
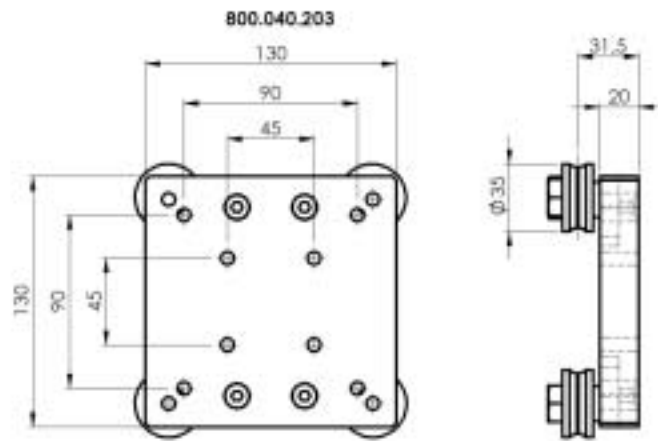
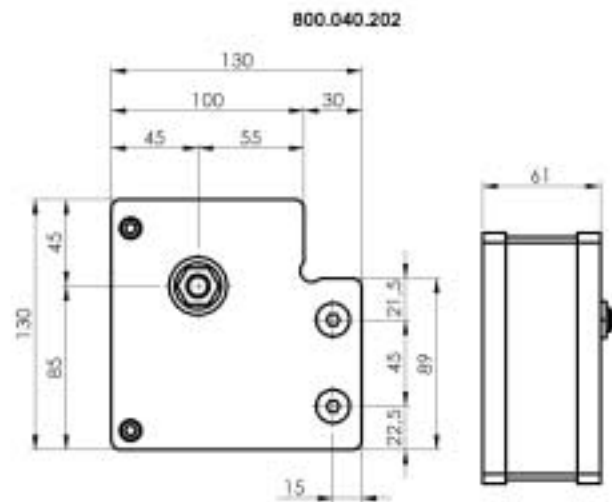
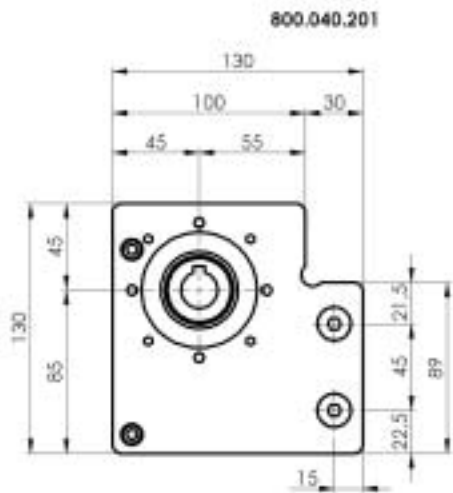



CARRELLO MOBILE - MOVABLE TROLLEY

CODICE CODE	DESCRIZIONE DESCRIPTION
800.040.303	Carrello mobile per guide serie 800.020 <i>Movable trolley for guides series 800.020</i>



CARRELLO MOBILE - MOVABLE TROLLEY

CODICE CODE	DESCRIZIONE DESCRIPTION
800.040.410	Carrello mobile per guide serie 800.030 <i>Movable trolley for guides series 800.030</i>



ADATTATORE - ADAPTER

CODICE CODE	DESCRIZIONE DESCRIPTION	MATERIALE MATERIAL
800.040.014	Adattatore per motoriduttori MVF30F <i>Adapter for gear motors MVF30F</i>	Alluminio anodizzato <i>Anodized aluminium</i>



PERNO DI TRAINO - DRIVE PIN

CODICE CODE	DESCRIZIONE DESCRIPTION	MATERIALE MATERIAL
800.040.015	Perno per motoriduttori MVF30F <i>Gear motor pivot MVF30F</i>	Acciaio zincato <i>Galvanized steel</i>

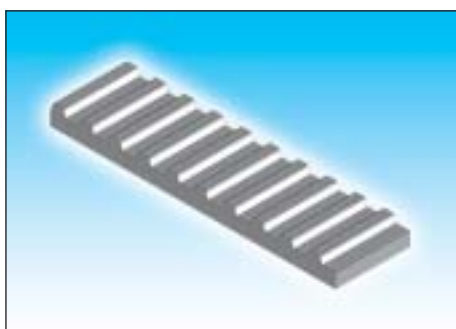

CINGHIA DENTATA - TOOTHED BELT

CODICE CODE	DESCRIZIONE DESCRIPTION
800.040.016	Cinghia dentata AT10 L = 16 mm per guide serie 800.010 e 800.030 <i>Toothed belt AT10 L = 16 mm for guides series 800.010 and 800.030</i>
800.040.017	Cinghia dentata AT10 L = 25 mm per guide serie 800.020 <i>Toothed belt AT10 L = 25 mm for guides series 800.020</i>

800.040.303

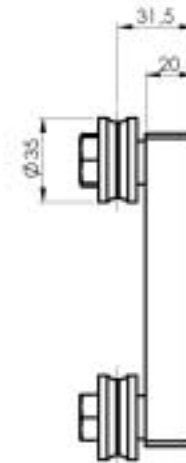
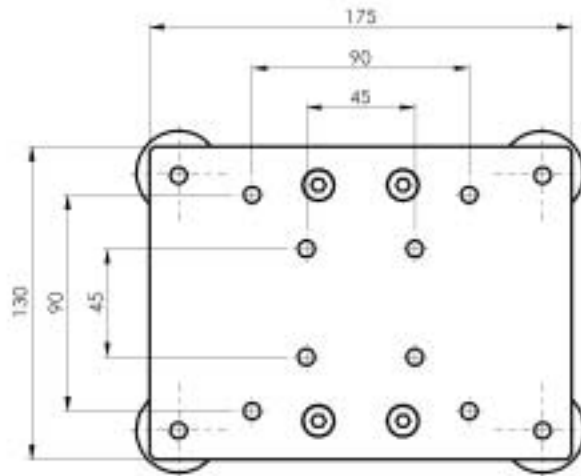

800.040.410

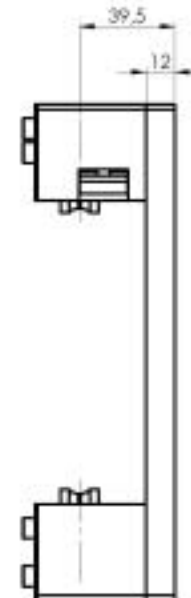
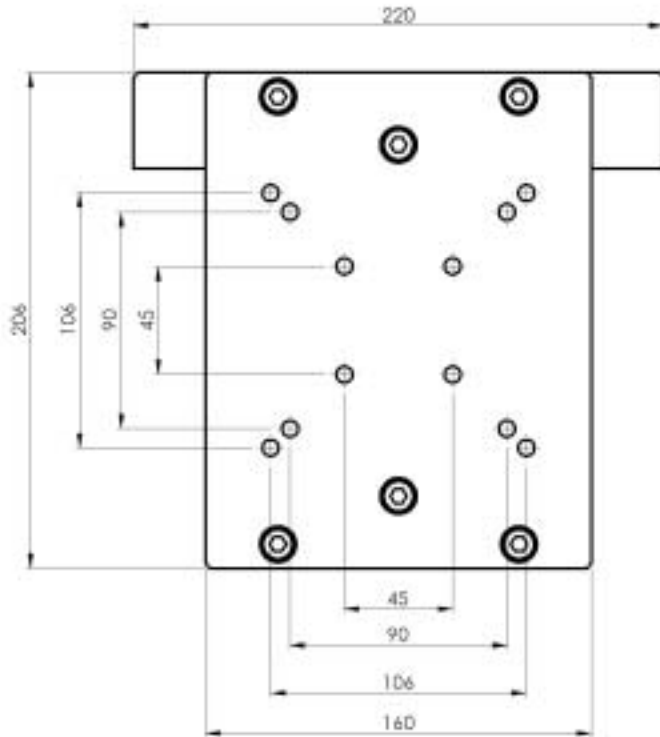

800.040.014

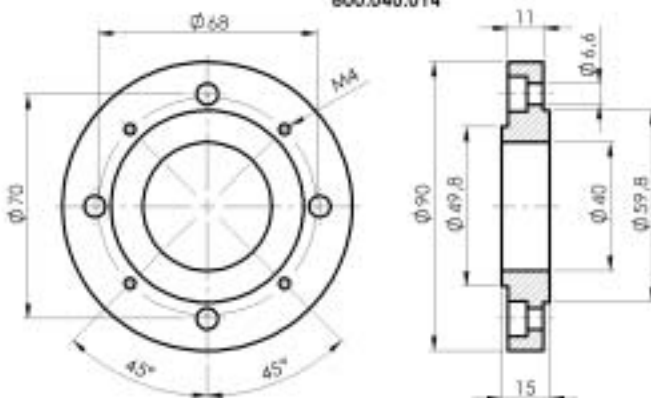

800.040.015

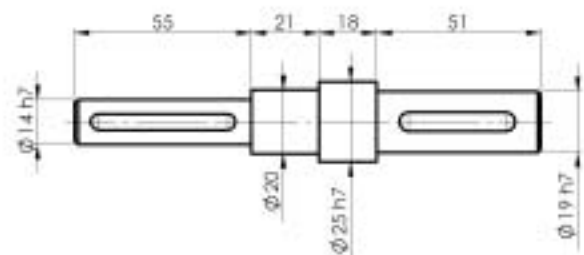

GUIDE LINEARI SERIE 800.010
LINEAR GUIDES SERIES 800.010

Di seguito sono riportate le dimensioni della Guida Lineare Serie 800.010 con struttura in profilo Alusic 45x90 e guide in acciaio temprato Ø 12

The drawings here below illustrate the dimensions of the Linear Guide of the Series 800.010 with Alusic 45x90 profile structure and hardened steel rails Ø 12

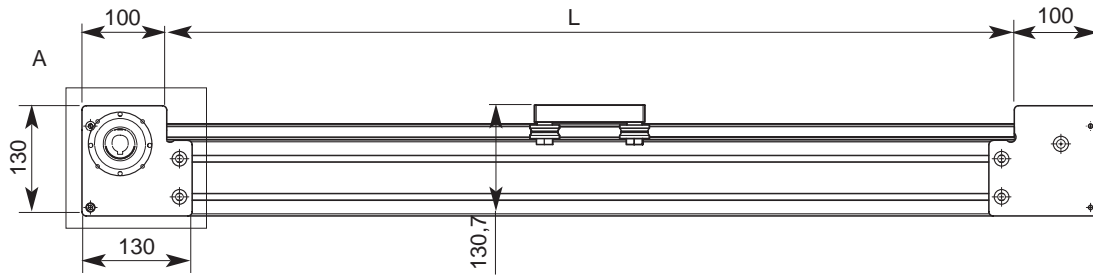

CORSA CARRELLO MOBILE = L-130
 L = lunghezza profili in alluminio con guide Ø 12
 RUN OF THE MOVABLE TROLLEY = L-130
 L = aluminium profile length with guides Ø 12

Dettaglio A per motoriduttori MVF30F
 Detailed picture A for gear motors MVF30F

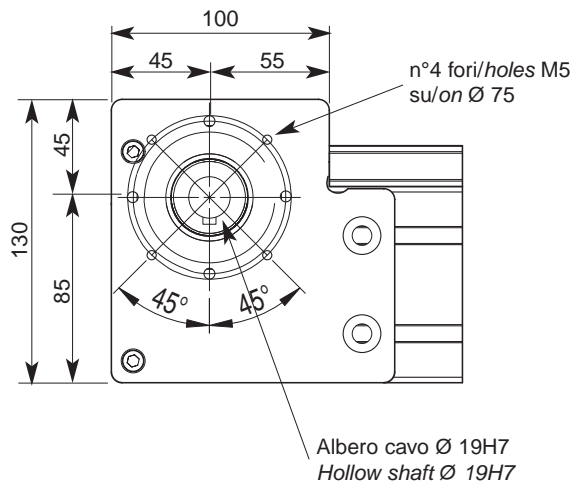
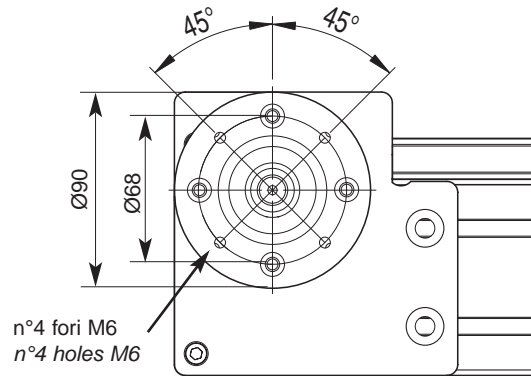

Dettaglio A per motoriduttori BRUSHLESS
 Detailed picture A for gear motors BRUSHLESS

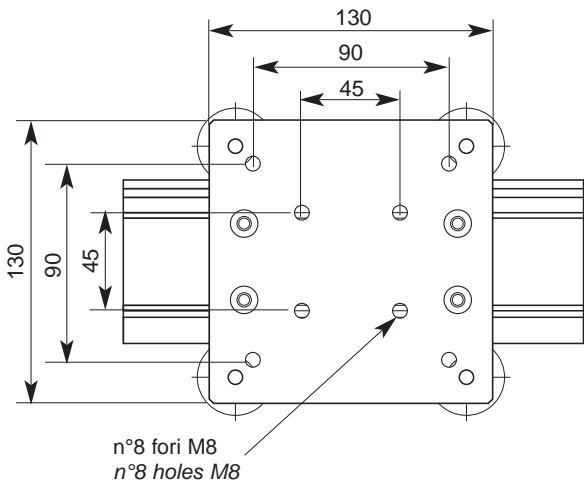
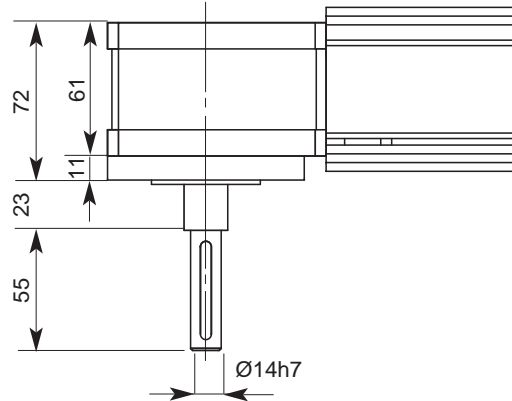

Dettaglio carrello mobile
 Detailed picture movable trolley

Vite concentrica
 Concentric screw
 084.529.005

Tondo
 Round bar
 800.040.018

Vite eccentrica
 Eccentric screw
 084.529.004

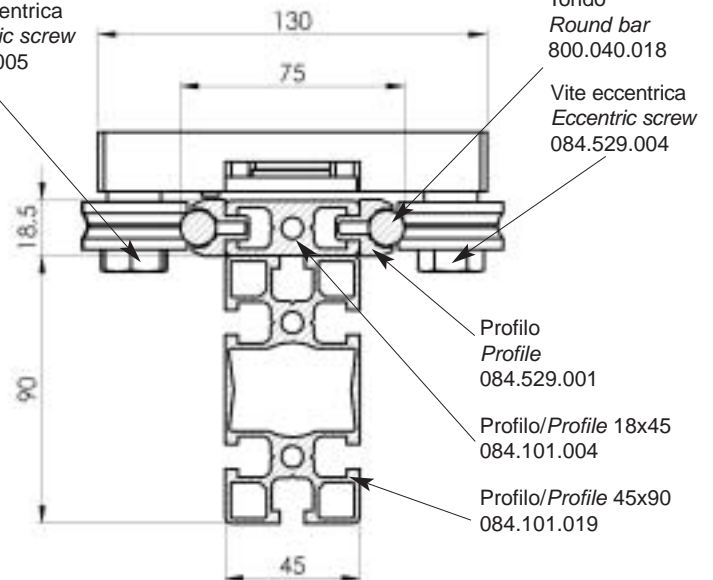

Profilo
 Profile
 084.529.001

Profilo/Profile 18x45
 084.101.004

Profilo/Profile 45x90
 084.101.019

GUIDE LINEARI SERIE 800.020
LINEAR GUIDES SERIES 800.020

Di seguito sono riportate le dimensioni della Guida Lineare Serie 800.020 con struttura in profilo Alusic 90x90 e guide in acciaio temprato Ø 12

The drawings here below illustrate the dimensions of the Linear Guide of the Series 800.020 with Alusic 95x90 profile structure and hardened steel rails Ø 12

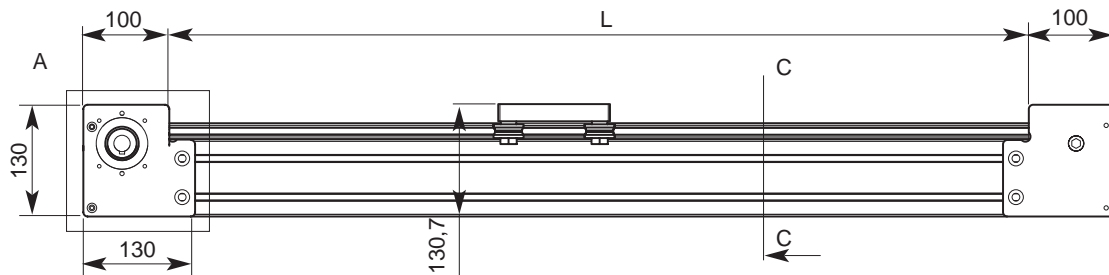

CORSA CARRELLO MOBILE = L-130
 L = lunghezza profili in alluminio con guide Ø 12
 RUN OF THE MOVABLE TROLLEY = L-130
 L = aluminium profile length with guides Ø 12

Dettaglio A per motoriduttori MVF30F
 Detailed picture A for gear motors MVF30F

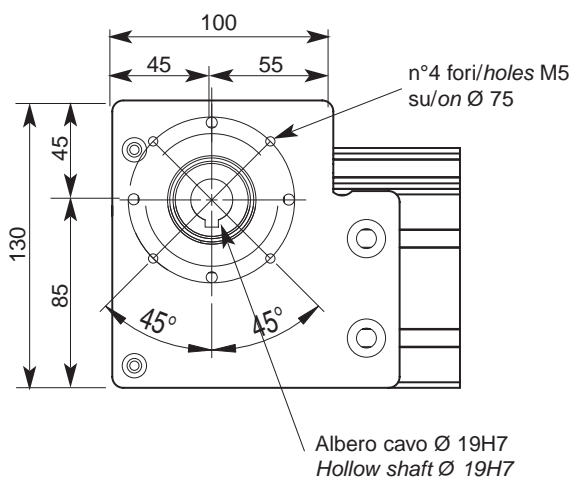
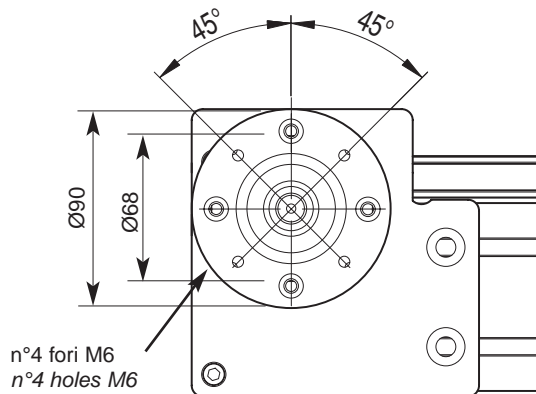

Dettaglio A per motoriduttori BRUSHLESS
 Detailed picture A for gear motors BRUSHLESS

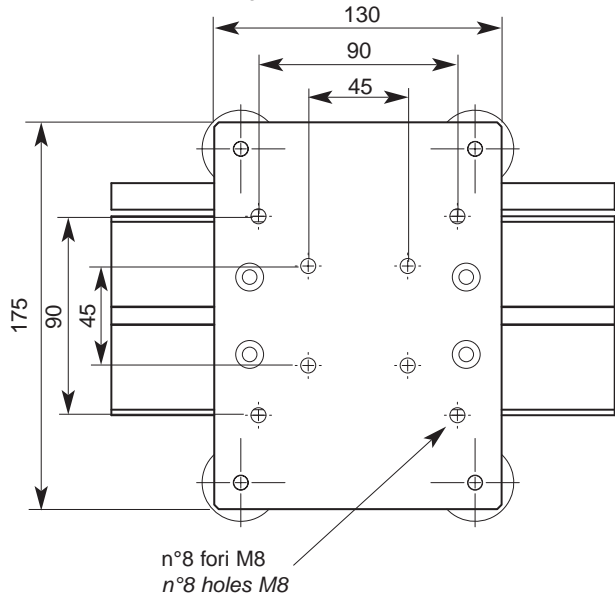

Dettaglio carrello mobile
 Detailed picture movable trolley

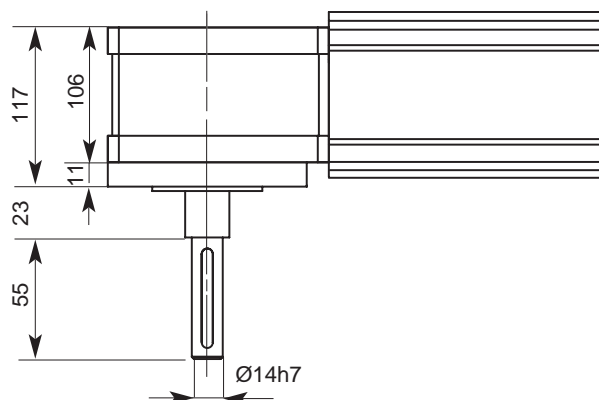

Vite concentrica
 Concentric screw
 084.529.005

Tondo
 Round bar
 800.040.018

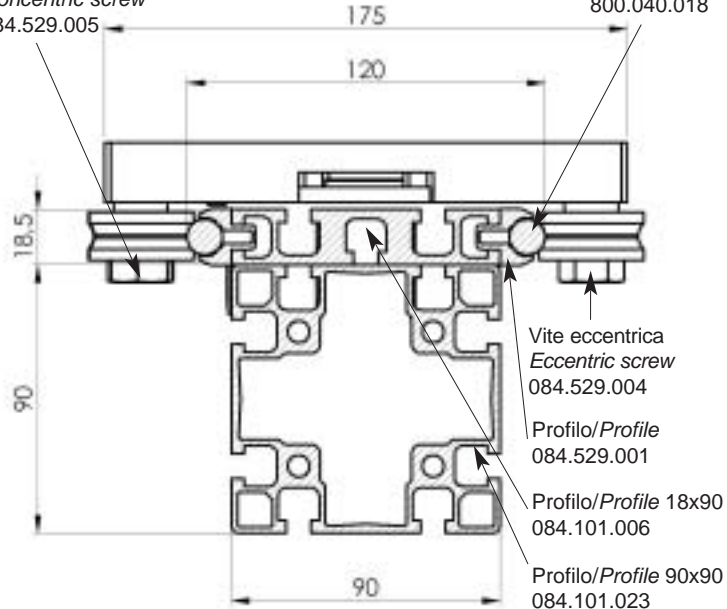

Vite eccentrica
 Eccentric screw
 084.529.004

Profilo/Profile
 084.529.001

Profilo/Profile 18x90
 084.101.006

Profilo/Profile 90x90
 084.101.023

GUIDE LINEARI SERIE 800.030
LINEAR GUIDES SERIES 800.030

Di seguito sono riportate le dimensioni della Guida Lineare Serie 800.030 con struttura in profilo Alusic 45x90 e guide in acciaio temprato Ø 12

The drawings here below illustrate the dimensions of the Linear Guide of the Series 800.030 with Alusic 45x90 profile structure and hardened steel rails Ø 12

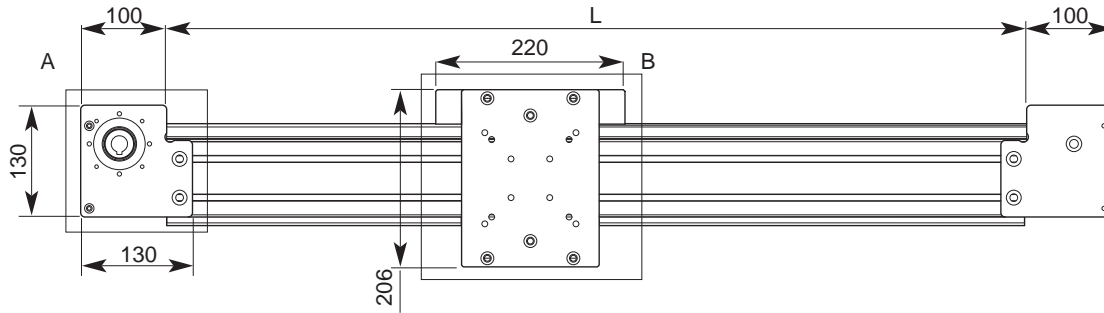

CORSA CARRELLO MOBILE = L-220
 L = lunghezza profili in alluminio con guide Ø 12
 RUN OF THE MOVABLE TROLLEY = L-220
 L = aluminium profile length with guides Ø 12

Dettaglio A per motoriduttori MVF30F
 Detailed picture A for gear motors MVF30F

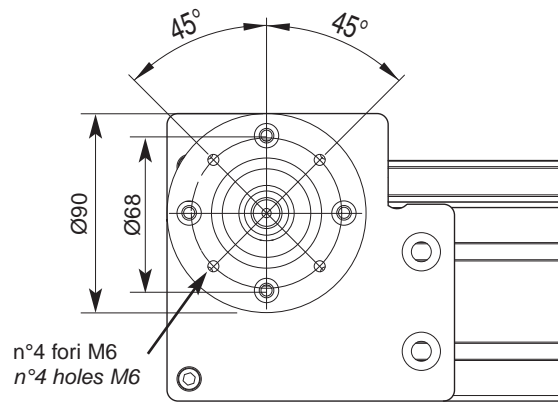
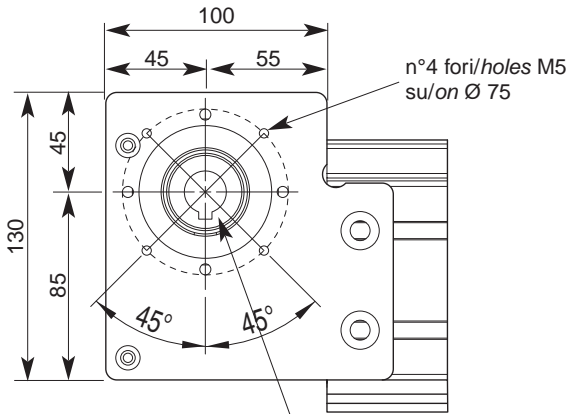

Albero cavo Ø 19H7
 Hollow shaft Ø 19H7

Dettaglio A per motoriduttori BRUSHLESS
 Detailed picture A for gear motors BRUSHLESS

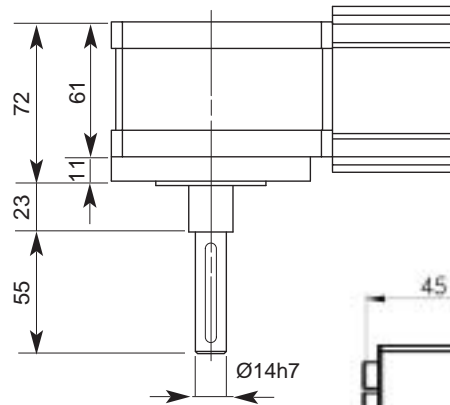

Tondo
 Round bar
 800.040.018

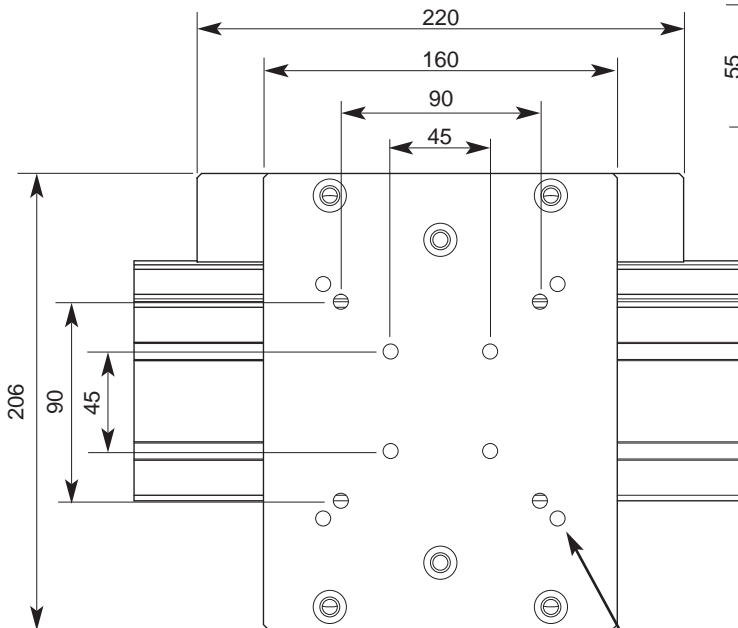

Dettaglio B - Carrello mobile verticale
 Detailed picture B - Vertical movable trolley

n°12 fori M8
 n°12 holes M8

Profilo/Profile
 084.529.001

Profilo/Profile 45x90
 084.101.019

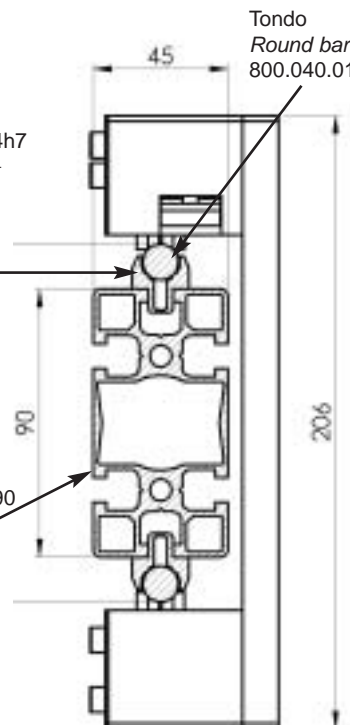

**CARICHI SOPPORTABILI
BEARABLE LOADS**

Di seguito sono riportati i carichi limite F_x , F_y (N) e M_z (Nm) sopportabili dal carrello mobile
The table here below shows the maximum weights F_x , F_y (N) and M_z (Nm) the movable trolley can move

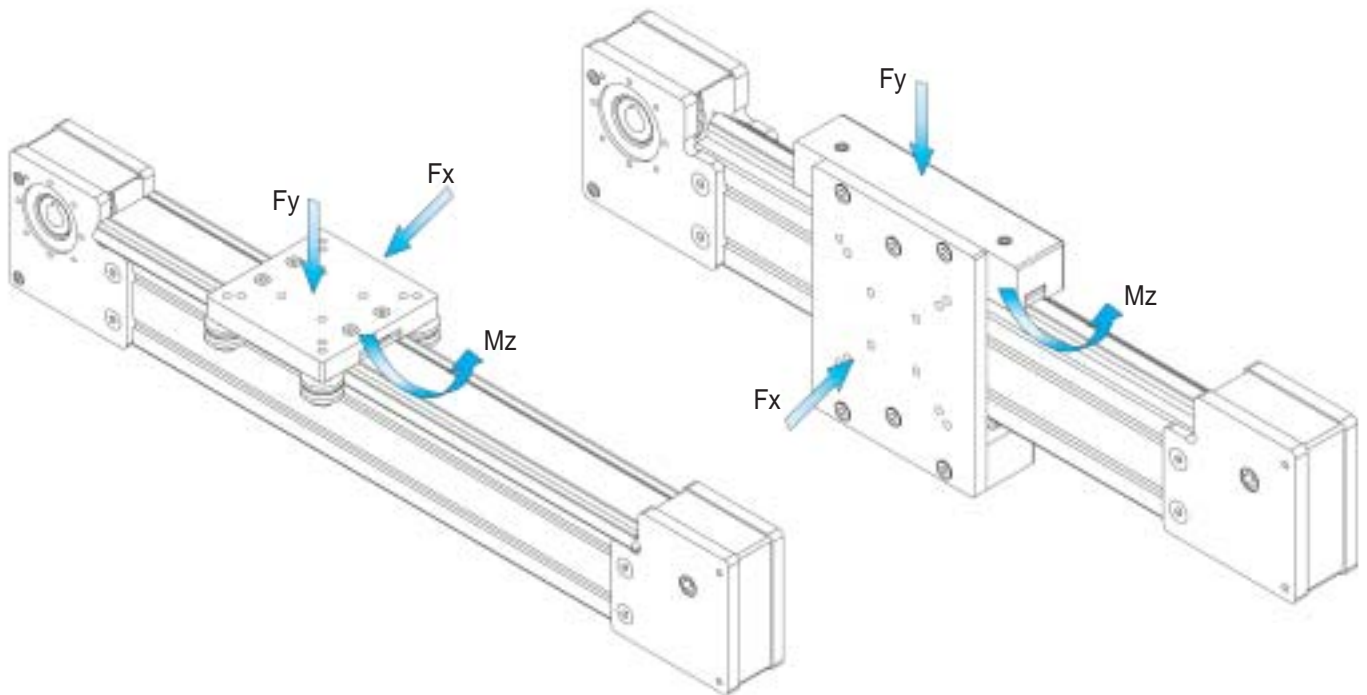

CODICE CODE	CARICO F_x (N) FORCE F_x (N)	CARICO F_y (N) FORCE F_y (N)	MOMENTO M_z (Nm) MOMENT M_z (Nm)
800.010	500	500	30
800.020	500	500	40
800.030	500	500	35

La velocità massima del carrello a carico massimo è di 1 m/s
The maximum speed of carriage at maximum load is 1 m/s

Per calcolare la portata dei profili in alluminio consultare il catalogo Alusic
To calculate the load of the aluminium profiles consult the catalogue Alusic

CODIFICA DELLE GUIDE LINEARI / CODIFICATION OF THE LINEAR GUIDES

800.010.xxxx

____ Lunghezza "L" profili in alluminio / Aluminium profile length "L"

Codice Guida Lineare / Linear Guide Code

800.010 - Guida orizzontale realizzata in profilo 45x90 / Horizontal guide realized with profile 45x90

800.020 - Guida orizzontale realizzata in profilo 90x90 / Horizontal guide realized with profile 90x90

800.030 - Guida verticale realizzata in profilo 45x90 / Vertical guide realized with profile 45x90

ESEMPIO DI ORDINAZIONE / EXEMPLE OF ORDER

800.020.1250 - Guida Lineare con telaio in profilo Alusic 90x90 / Linear Guide with frame realized with Alusic profile 90x90
carrello in alluminio orizzontale e lunghezza utile L = 1250 mm / aluminium horizontal trolley and length L = 1250 mm